



seeTemp™ Wall Control in White

Wireless Temperature Sensor in Snow

HVAC Controller

# Temperature Control from Lutron®



# Lutron Temperature Control

## Why temperature control?

Lutron light and shade controls have always saved energy. So expanding our energy-saving solutions beyond light control was only natural.

Lutron temperature control was designed to work in conjunction with our total home control systems, and provides convenience, flexibility and energy savings in an aesthetically pleasing design.

## What is it?

Lutron has developed a three-part thermostat:



The **seeTemp™ wall control** shows current room temperature and set point, and allows you to adjust set point and system mode (heating, cooling, auto, fan on/off).



The **wireless temperature sensor** (battery-powered) is surface-mounted to the wall in the living space. It detects temperature and transmits that information to the HVAC controller.



The **HVAC controller** receives wireless commands from the seeTemp wall control and wireless temperature sensor, then controls HVAC equipment using 24V relays. The HVAC controller also communicates with the main repeater to integrate temperature control into your RadioRA® 2 system.



seeTemp Wall Control

Wireless Temperature Sensor

# Benefits

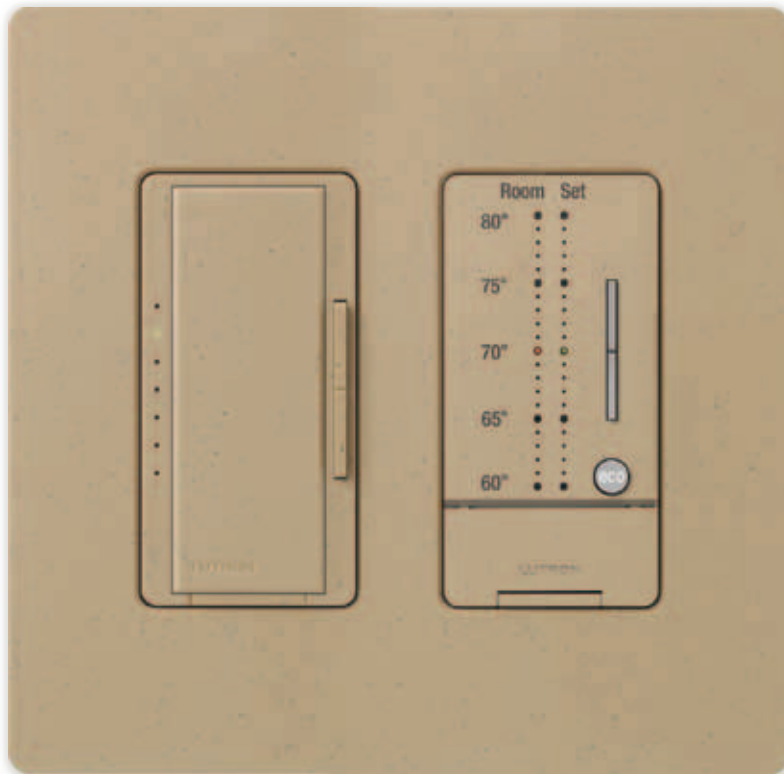

RadioRA® 2 dimmer ganged with seeTemp Wall Control

White	Ivory	Almond
Light Almond	Gray	Brown
Black	Hot	Merlot
Plum	Turquoise	Taupe
Eggshell	Biscuit	Snow
Palladium	Midnight	Sienna
Terracotta	Greenbriar	Bluestone
Mocha Stone	Goldstone	Desert Stone
Stone	Limestone	

## Aesthetics

- The seeTemp™ wall control's elegant, slim, flush-mounted design allows it to blend in with a room's décor.
- Reduce wall clutter by installing the seeTemp wall control in any wallbox, either ganged with dimmers and keypads or on its own.
- The seeTemp wall control is available in gloss and Satin Colors® (shown above right) to match any décor.

## Flexibility

- Each component of the thermostat is installed where it makes the most sense.
- The seeTemp wall control is placed wherever control is desired, without regard for the local temperature.
- The wireless temperature sensor is placed where readings will be most accurate—no need to run wires to that location.
- The HVAC controller is installed out of sight near the equipment it is controlling.

Temperature control from Lutron is available for **RadioRA® 2** and **HomeWorks® QS** (coming soon) total home control systems.

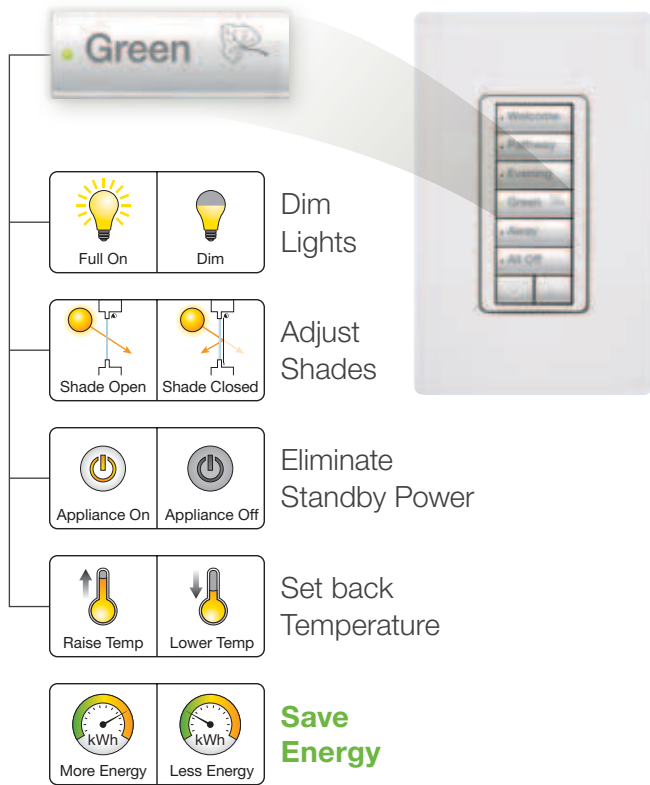

## Energy Savings

- Save up to 16% of the energy used on HVAC<sup>1</sup> with Lutron® temperature control.
- Automatically reduce HVAC use at night, while away, or during other times it isn't needed with temperature scheduling.
- Use the "Green" button (shown above) to control lights, shades, appliances and temperature as part of a whole home system. The "Green" button dims lights 5%, lowers shades to block heat gain and sets back the temperature 2° F. You can save more by personalizing these settings.

<sup>1</sup> www.energystar.gov

## Convenience

- Control the temperature from anywhere via seeTemp™ wall controls, system keypads, your iPad®, iPhone®, iPod touch®, or 3rd-party remote controls and touchscreens.
- Automatically schedule your thermostat to turn off after you leave for work and turn on before you return.

iPhone, iPod touch, and iPad are registered trademarks of Apple®, Inc., registered in the U.S. and other countries.

# Product Features

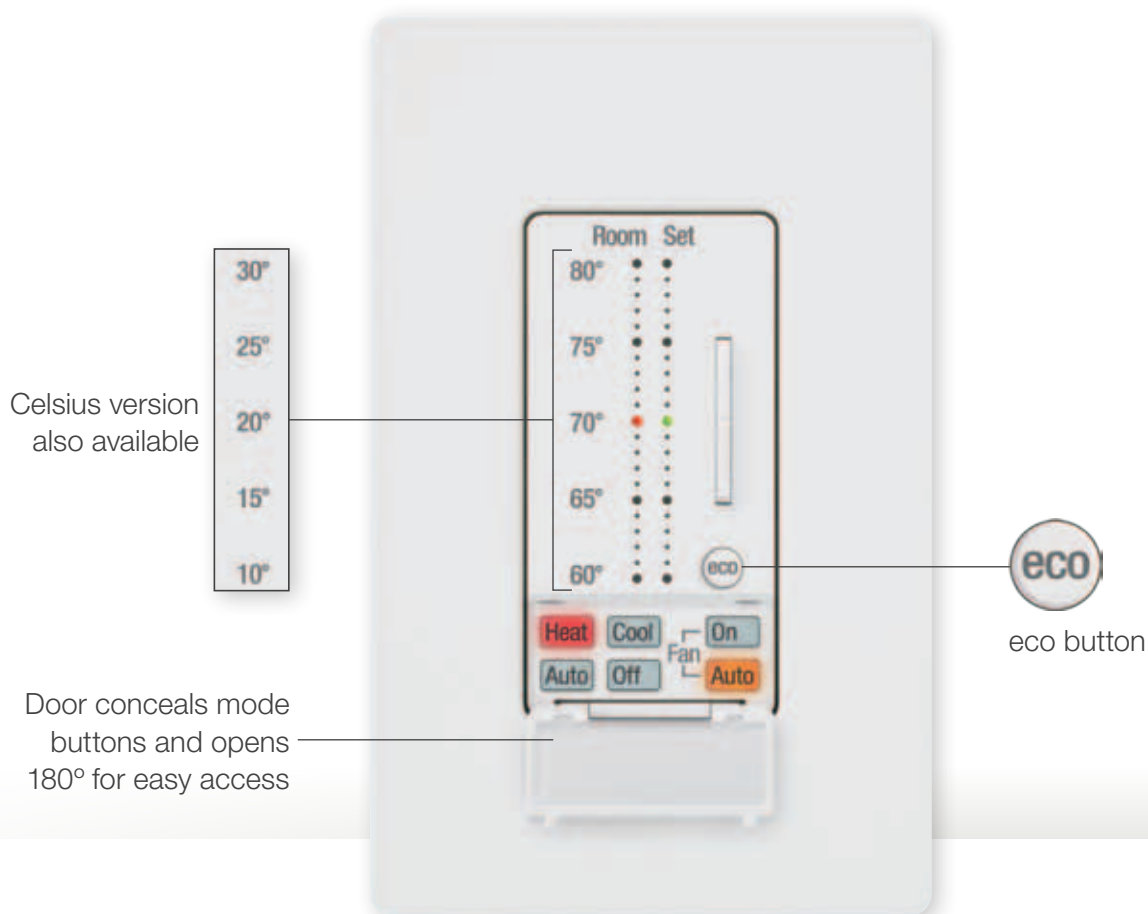

## seeTemp™ Wall Control

- eco button adjusts temperature 2° F to save energy without sacrificing comfort
- Celsius and Fahrenheit versions available
- Communicates via Lutron Clear Connect™ RF Technology to ensure reliable communication and consistent performance



## Wireless Temperature Sensor

- No wires—5 year battery life
- If more than one sensor is associated with an HVAC controller, temperatures are averaged
- Communicates via Lutron Clear Connect™ RF Technology



## HVAC Controller

- Connects to and controls HVAC equipment using standard low-voltage thermostat wiring
- Integrates temperature control with a Lutron® whole-home control system
- Communicates via Lutron Clear Connect RF Technology
- Includes wired backup sensor to be installed in return air duct

**Note:** HVAC controller should be installed by a professional HVAC contractor

# System Control Options

## iPad®, iPhone®, iPod Touch®

View the current temperature, adjust the set point and system mode, and manage your thermostat schedule. Use it for convenience while at home, or while you're away.



## seeTemp™ Wall Control

Control basic thermostat settings from a convenient location. Sleek design blends in with décor while the intuitive interface shows you the current temperature and set point at a glance. System mode buttons are available, hidden behind a door that opens 180° for easy access.



## seeTouch® Keypads

Include temperature control in whole-home scenes like a “Goodnight” button. When you press “Goodnight” the lights turn off and temperature sets back a few degrees to save energy overnight.

## “Away” Mode

Or if you're going on vacation, select “Away” mode to run a series of lighting events that make your home look occupied. “Away” mode can also maintain an energy-saving set point. If someone stops by and adjusts the temperature, the system will reinstate the “Away” set point—every 6 hours.



## 3rd-party Integration

View the current temperature and adjust the set point and system mode from your favorite home automation system or programmable remote control. Temperature control commands are available using Lutron's integration protocol via RS-232 or IP.



## Sensors

Lutron's Radio Powr Savr™ occupancy sensors can select a set point when a space is occupied, and another when the space is vacant, automatically saving energy when no one is around.



## HVAC Schedule

Automatically control your temperature to save energy using the 7-day, 4-event HVAC schedule. Events can include “wake,” “away,” “return,” “sleep”—or create your own.



# System Diagram

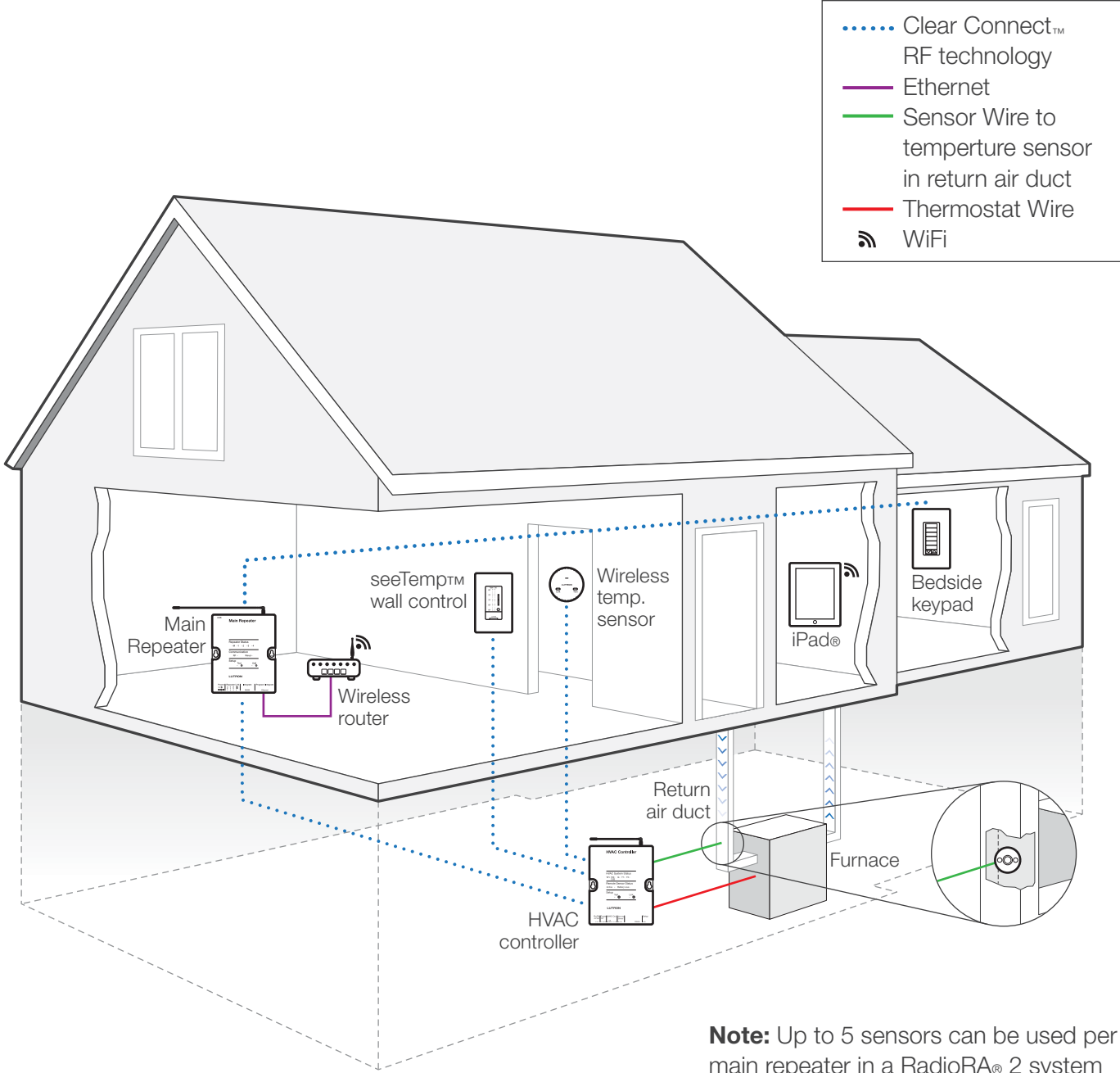

# HVAC System Compatibility

HVAC Type	Compatible?
Single Stage Cool	Yes
Two Stage Cool	Yes
Single Stage Heat	Yes
Two Stage Heat	Yes
Packaged Roof Top Units	Yes
Heat Pump	Yes
Dual Fuel Systems	Yes — Requires a separate Fossil Fuel Kit*
Geothermal Heat Pump	Yes
Heat Pump with Auxiliary Electric (Emergency) Heat	Yes
Typical Variable Speed Fan (Equipment Controlled)	Yes
Multi-Zone Systems (Controllable Dampers)	Yes — Requires a separate Zone Controller*
In-Floor Radiant Heat	Yes
Line Voltage Electric Baseboard	No
Mili-Volt System	No
Proprietary/Digital Control System	No
Variable Speed Fan (Independent Relays)	No
Humidity Control	No
Humidity Sensing	No
Outdoor Temperature Sensing	No

\*Not sold by Lutron

# Ordering Information

Model Number	Description	
LRD-WST-F-XX <sup>1</sup>	seeTemp™ wall control (Fahrenheit)	
LRD-WST-C-XX <sup>1</sup>	seeTemp wall control (Celsius)	
LRF2-TWRB-XX <sup>2</sup>	Wireless temperature sensor	
LR-HVAC-INT-XX <sup>2</sup>	Temperature control integration package (1) LRF2-TWRB-XX <sup>2</sup> (1) HVAC Controller	
LR-HVAC-PKG-WH <sup>3</sup>	Temperature control package with seeTemp (1) LRF2-TWRB-SW (1) HVAC Controller (1) LRD-WST-F-WH	

<sup>1</sup> Available in 27 gloss and Satin Colors®

<sup>2</sup> Available in Snow (SW) or Midnight (MN)

<sup>3</sup> Celcius version coming soon

For more information, please contact Technical Support (800.523.9466) or visit [www.lutron.com](http://www.lutron.com).